

REV.	DESCRIPTION	DATE	DRAFTER	APPROVER
A1	DWG.REL	2020.5.18	ZHANG	JIN

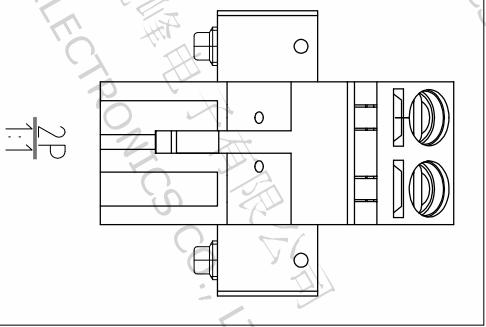
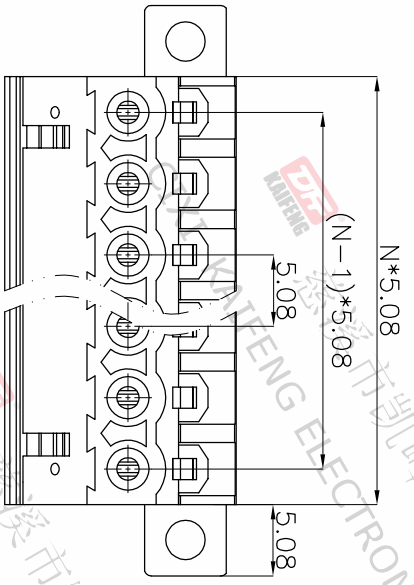
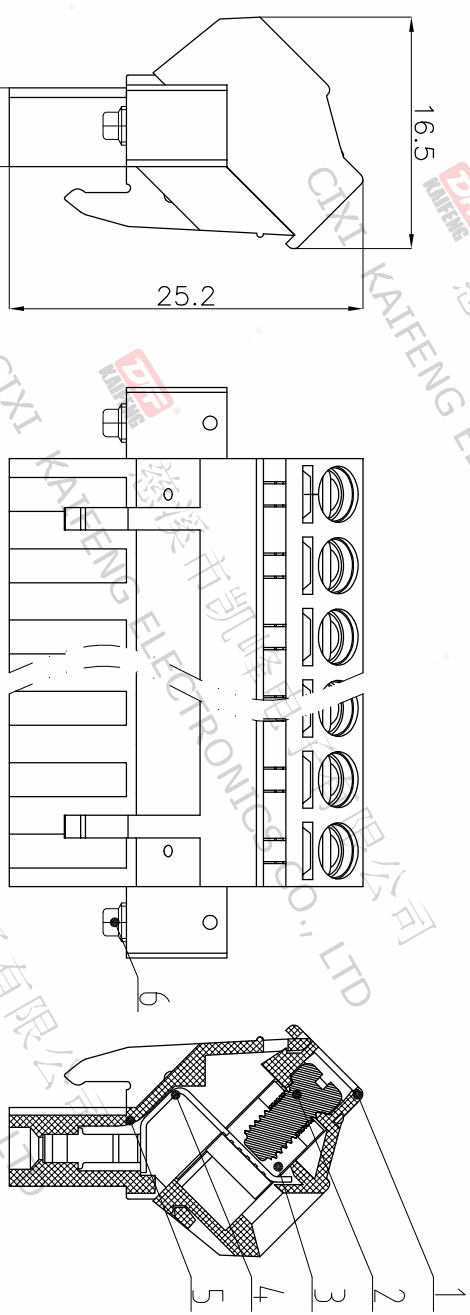

Pitch range	Nominal dimension range	PROJECTION
>0	>0	0.1/10
~6	~30	∠
~10	~60	∠
~24	~100	∠
±0.15	±0.30	±2°
±0.20	±0.30	
±0.30	±0.50	
±0.70	±1.00	
±1.30	±1.30	

DRAWING TYPE	CUSTOMER DRAWING	SHEET	1 OF 1
SCALE	1:1	SHEET	1 OF 1
DRAWING NO.	W10002052		

- RoHS compliance
- HOW TO ORDER  
KF2EKLM-5.08-XXP-1 X-XXXXX
- MODEL Pitch:mm
- No. of poles: 2~24P
- Color: Customer Request  
G:Green R:Red  
K:Black W:White  
O:Orange B:Blue  
GR:Grey
- 1:Single Pitch  
2:Double Pitch

- Mechanical  
Operating temperature: -40°C ~ +105°C  
Soldering temperature: 250°C ± 5 / 5sec  
Torque: 0.5N.m (4.43lb.in)  
Strip length: 10-11mm
- Electrical  
Rated voltage : 300V  
Rated current : 15A  
Contact resistance : 20mΩ(Max)  
Insulation resistance: 500MΩ/DC500V  
Withstanding Voltage : AC2000V/1min  
Wire range: 26-12AWG 2.5mm<sup>2</sup>

- Material  
①Housing : PA66, UL94V-0  
②Screw : M3.0 steel, Zn plated  
③Clamp : Copper alloy, Ni plated  
④Contact : Copper alloy, Ni plated  
⑤Cover : PA66, UL94V-0  
⑥Screw : M2.5 steel, Zn plated

TITLE: KF2EKLM-5.08-XXP-1X  
UNIT: mm  
SHEET SIZE: A4  
SERIES: KF2EKLM

**DF** 慈溪市凯峰电子有限公司  
CIXI KAIFENG ELECTRONICS CO.,LTD